

## acuraSpace PRO<sup>+</sup> High Performance Filter Element

acuraSpace PRO<sup>+</sup> High Performance Filter Elements combine the advantages of conventional filter bags and filter cartridges in one filter element. Compared to a standard filter bag our

**patented folding** will have a much larger filter area (up to 6.0 m<sup>2</sup> instead of 0.5 m<sup>2</sup>). Life and dirt holding capacity will increase by many times. Similar to the filter bag, the **filtration will be from the inside to the outside**.

While replacing the filter element, all dirt particles will retain inside the filter element and avoid a contamination of the clean side of the filter housing. The element can be installed in every standard bag filter housing **without an additional support adaptor** with the novel **support collar acuraFlex PRO<sup>+</sup>**. Optionally a **magnet bar** can be insert to increase the service life of the element.

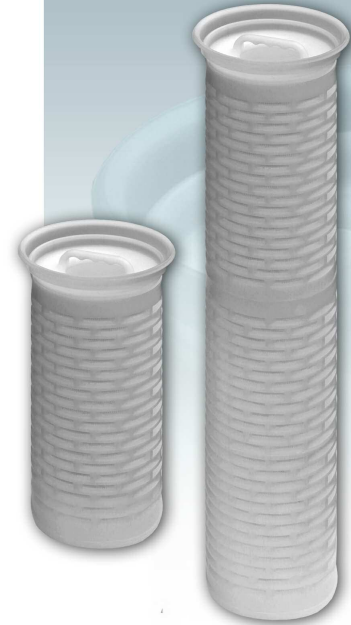
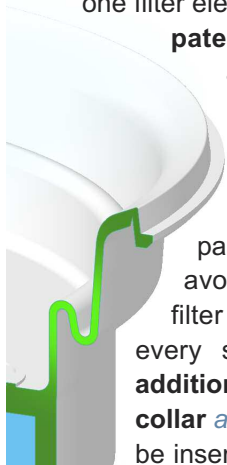

Functional principle:

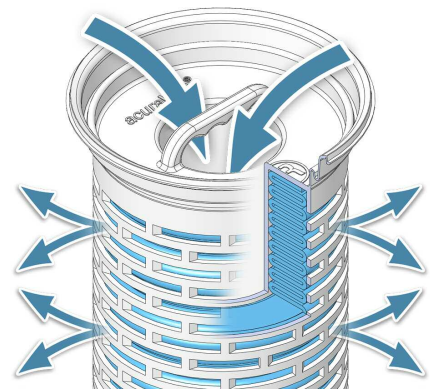

### TECHNICAL DATA

acuraSpace PRO<sup>+</sup>

Material		Micron rate	Temperature
Polypropylene		2 - 70 µm	max. 80°C
Δp 20°C	Δp 80°C	Filter area size 1	Filter area size 2
2,5 bar	1,3 bar	2,7 m <sup>2</sup>	6 m <sup>2</sup>

### FLOW RATE

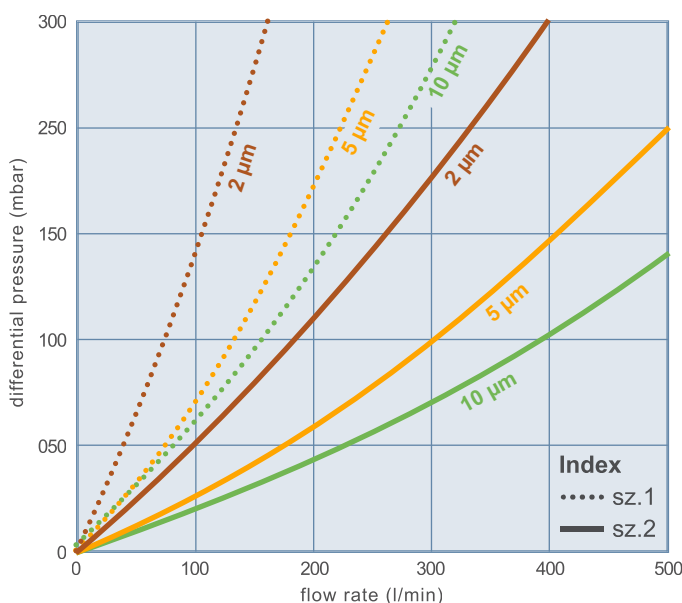

### EFFICIENCY

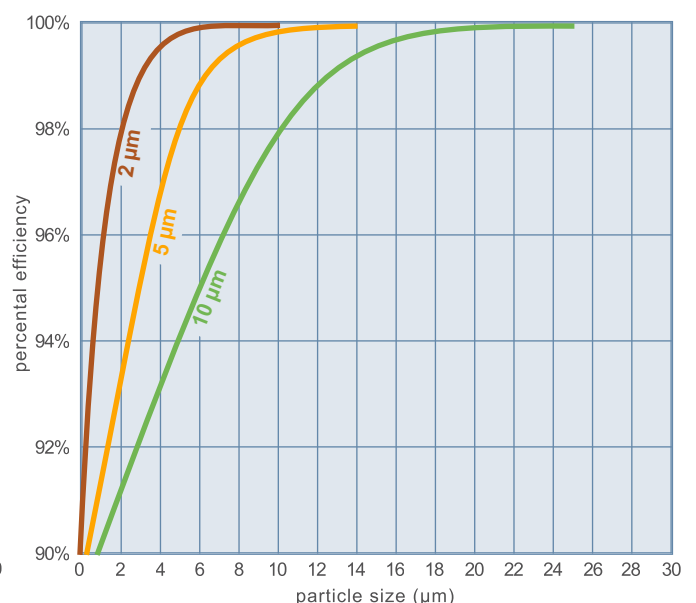

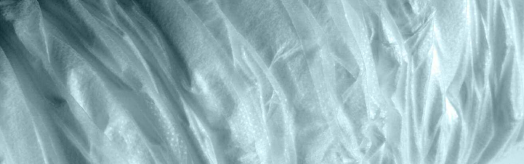

## APPLICATIONS

- Coating
- Pharmaceutical products
- Drinking water
- Cosmetics
- Process water
- Cleaning solutions
- Organic solvents
- Ink and paintings
- Petrochemistry
- Hydrocarbons
- Magnetic media dispersions
- Food and beverage

## HANDLING AND FILTER REPLACEMENT

**acuraSpace PRO<sup>+</sup>** High-Performance Filter Elements can be installed easily in **every existing bag filter housings of size 1 and 2**. The element can be installed **without an additional support adaptor** with the novel **support collar acuraFlex PRO<sup>+</sup>** and guarantees a by-pass-free filtration. **acuraSpace PRO<sup>+</sup>** High-Performance Filter Elements will be flow from the inside through the outside. This will retain all the dirt particles inside of the filter element and avoid a contamination of the clean side of the filter housing. Optionally a **magnet** can be insert into the element.



## SET-UP FROM BAG TO **acuraSpace PRO<sup>+</sup>**

This innovative product is protected with an international design registration.

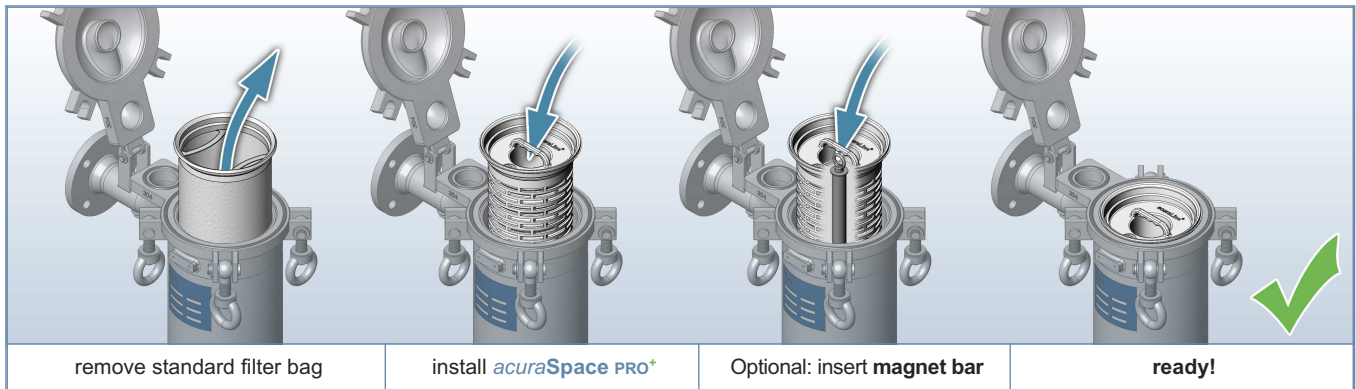

## ORDERING INFORMATION FOR FILTER ELEMENTS **acuraSpace PRO<sup>+</sup>** PERFORMANCE

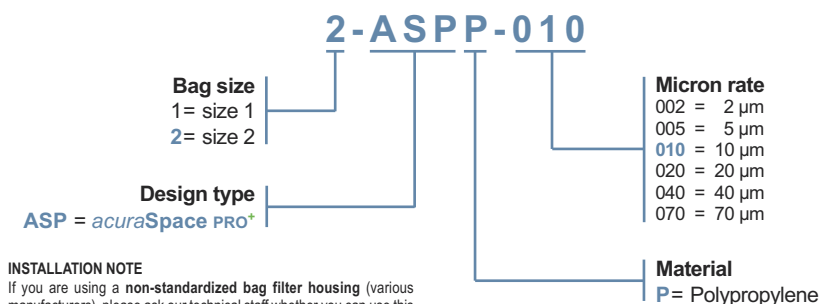

**INSTALLATION NOTE**  
If you are using a **non-standardized bag filter housing** (various manufacturers), please ask our technical staff whether you can use this High Performance Element without an additional **length-adjustment adaptor**. A length compensation adapter can **easily be setup** for the housing which differs from the standard.

Subject to technical alterations.  
AL1095-00-E - page 2/2

- High dirt load
- High flow rate
- Very large filter area
- Compact, space-saving design
- Easy and clean handling
- No contamination during replacing
- Low differential pressure
- By-pass free filtration
- Minimal set-up costs

**acuraLine<sup>®</sup>**